



# Building Healthy Relationships through Peer review in Simulation Education

Jennifer Dwyer MSN, FNP, RN BC, CHSE  
Education Specialist/Simulationist

Greg Hasty CST, LPN, CHSE  
Coordinator/Simulationist



Indiana University Health

## Goals & Objectives

---

TOGETHER WE'RE  
STRONGER



- Describe a tool that is utilized to provide peer review for events using simulation methodologies within the joint setting of a healthcare institution, school of medicine and school of nursing.
- Discuss lessons learned from the peer review process and modification made since implementing at the Simulation Center.

# Simulation Center

TOGETHER WE'RE  
STRONGER

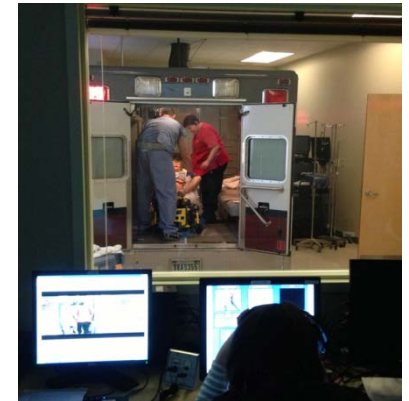

  
**INDIANA UNIVERSITY**  
SCHOOL OF MEDICINE



  
**SCHOOL  
OF NURSING**  
INDIANA UNIVERSITY



  
Indiana University Health



## The Simulation Center at Fairbanks Hall

Est. 2009

### FLOOR PLAN

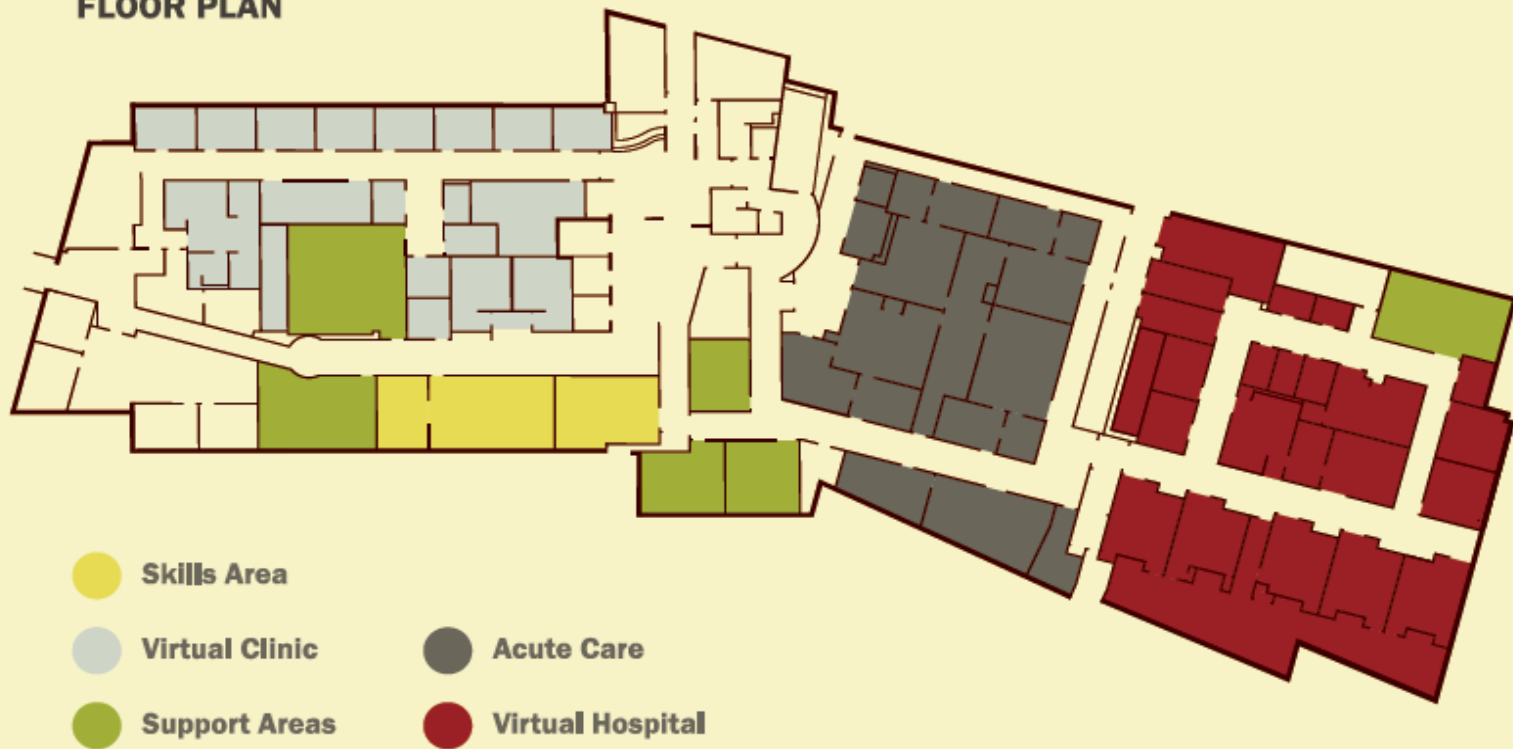

# Peer Review Process

---

TOGETHER WE'RE  
STRONGER



Academia – Medicine & Nursing

Service – Large Metropolitan Teaching Institution



# Peer Review Cycle

TOGETHER WE'RE  
STRONGER

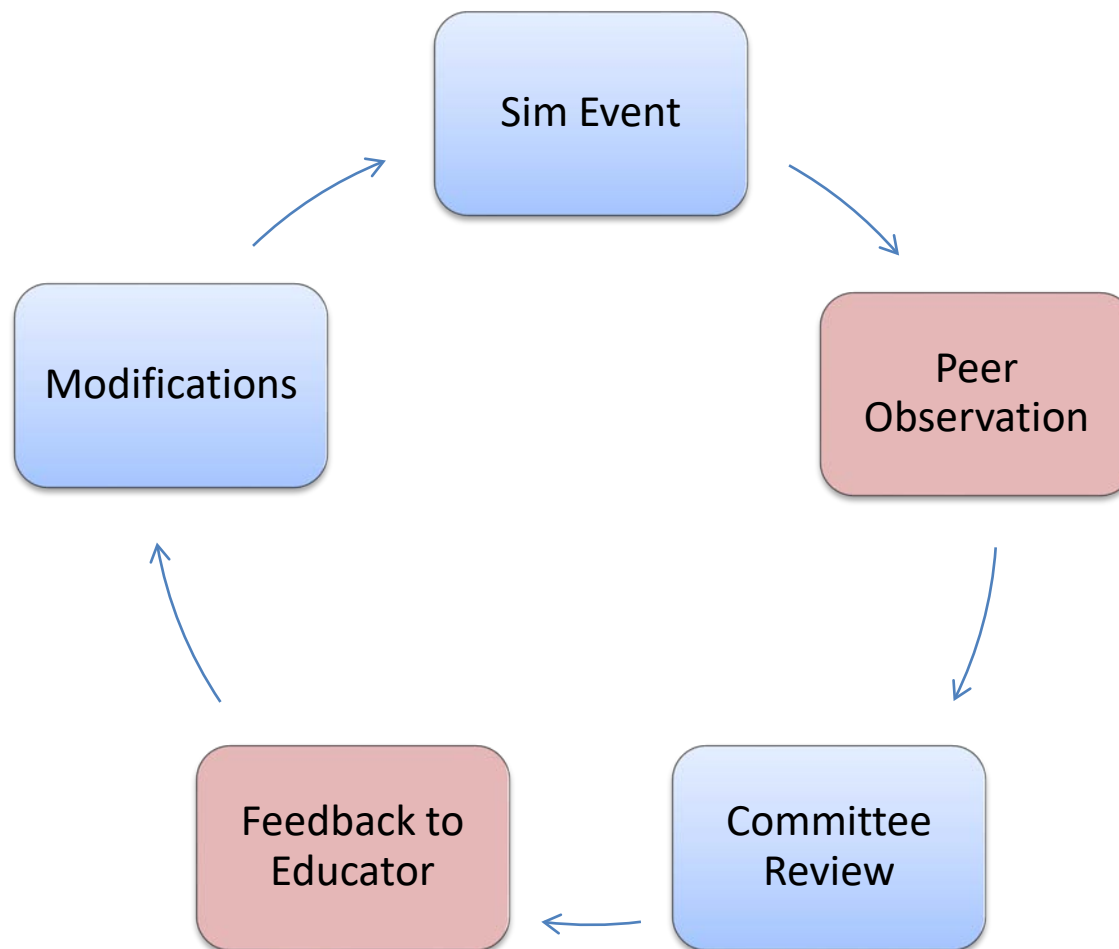



# Peer Observation

TOGETHER WE'RE  
STRONGER



## Simulation Event Review Form



<b>Session / Case Title:</b> _____		<b>Date:</b> _____
<b>Goals &amp; Objectives</b> <ul style="list-style-type: none"> <li>•</li> <li>•</li> <li>•</li> </ul>	<b>Modality:</b> Task Trainer    Mannequin    SP	
	<b>Educator(s):</b>	
	<b>Learners</b> <b>Institution:</b> <b>Level:</b> <b>Specific pre-session work:</b>	
<b>Resources to run event:</b> <b>Space:</b>  <b>Equipment:</b>  <b>Number of People:</b> ___ Specialists / Techs    ___ SPs    ___ Confederates / Embedded Participants ___ Educators    ___ Learners    ___ Other:		

# Peer Observation

TOGETHER WE'RE  
STRONGER



<b>Time:</b> <b>Overall:</b> <b>Orientation:</b> <b>Skills / Case(s):</b> <b>Debriefing(s):</b>	<b>Were learners... (Y/N)</b> ... oriented to the setting? ... aware of Goals and Objectives? ... oriented to the equipment? ... informed of the format of the session?
<b>Cases / Skills (comment on following)</b> <b>Realism (setting, learner roles):</b>  <b>Logistics / caseflow:</b>  <b>Confederates / Embedded Participants:</b>	
<b>Debriefing:</b> (Comment on format, learner safety, learner engagement, instructor knowledge & skills)	



# Peer Observation

TOGETHER WE'RE  
STRONGER



<b>What are the STRENGTHS of this event?</b>
<b>What are the OPPORTUNITIES for IMPROVEMENT of this event?</b>
<b>Is there opportunity for other learners to be involved? Which learners / professions / specialties?</b>
<b>Is there potential Scholarship with this event?</b>
<b>OVERALL COMMENTS</b>

Educational Committee Reviewers \_\_\_\_\_

# Peer Review Cycle

TOGETHER WE'RE  
**STRONGER**

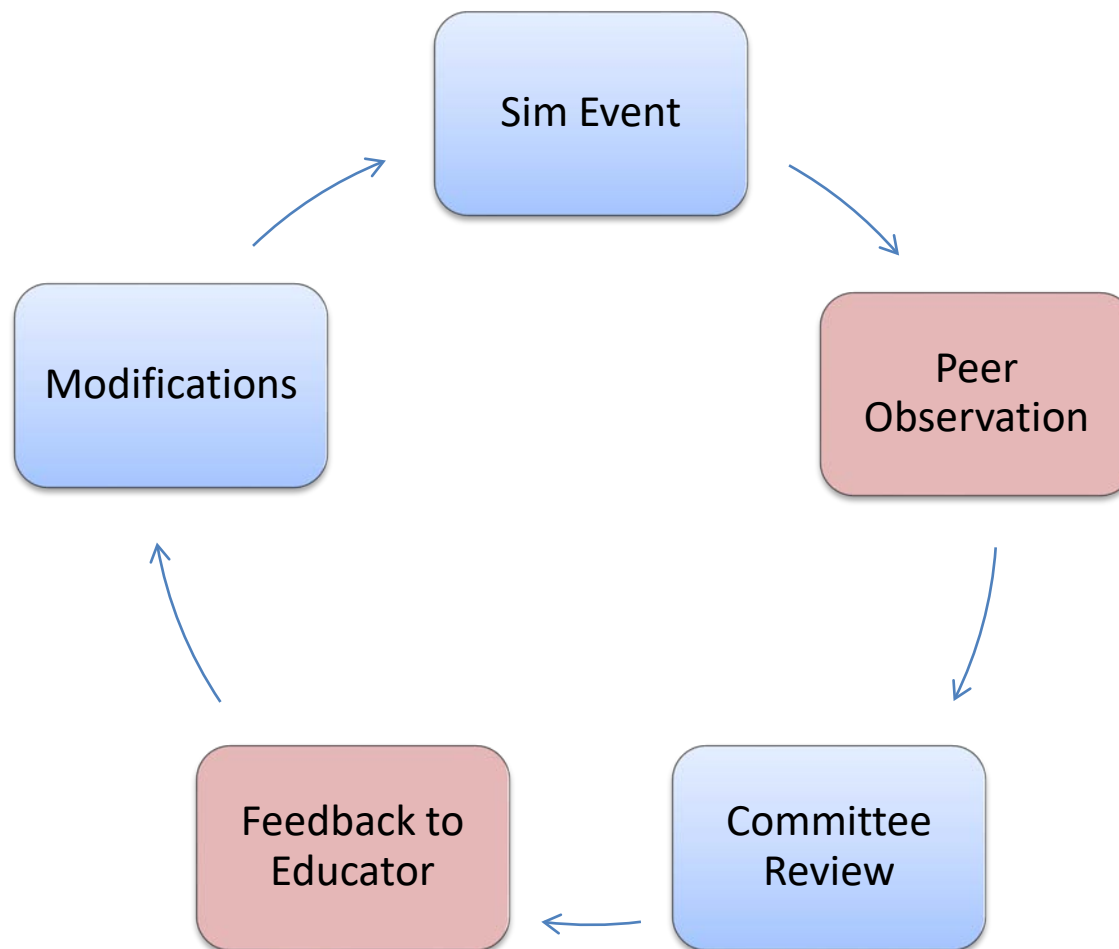

# SBAR

---

TOGETHER WE'RE  
STRONGER



Fairbanks Hall Simulation Center Educational Committee Event Review

Situation: (Title and learner / faculty groups)

Background: (when and how event was reviewed)

Assessment: (overall summary / description of the event, based upon goals and objectives, data gathered)

# SBAR

---

TOGETHER WE'RE  
STRONGER



Recommendation: (potential changes as recommended from reviewers and educational committee)

- 1.
- 2.
- 3.

# SBAR

---

TOGETHER WE'RE  
STRONGER



Reviewers: Simulation Center Education Team

If you have specific questions or would like to consult with the center for process improvement please contact us  
[simulationcenter@iuhealth.org](mailto:simulationcenter@iuhealth.org)

# Peer Review Cycle

TOGETHER WE'RE  
STRONGER

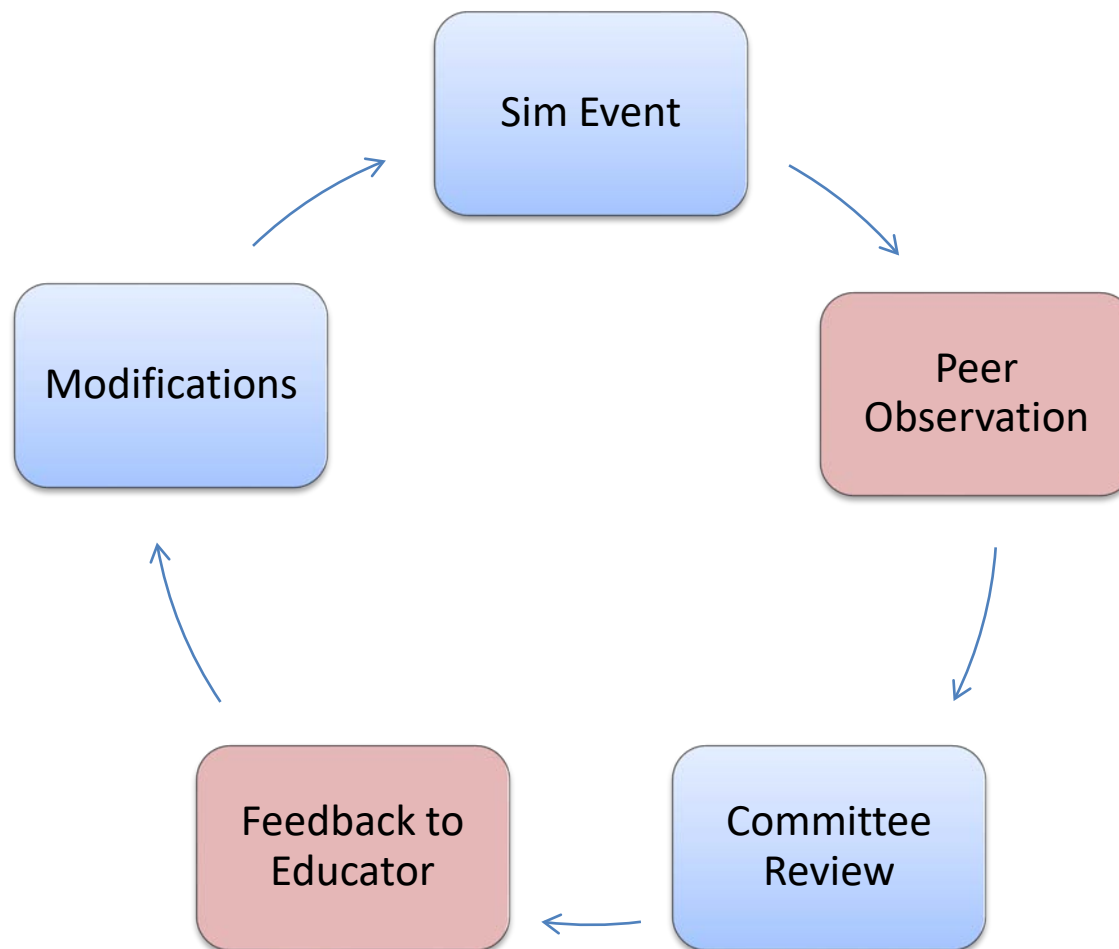

# Lessons Learned

---

TOGETHER WE'RE  
STRONGER



- How to approach other educators
- Ensure interprofessional representation
- Confer feedback
- Maintain professionalism



- Questions?
- Jennifer Dwyer – [jdwyer@iuhealth.org](mailto:jdwyer@iuhealth.org)
- Greg Hasty – [ghasty@iuhealth.org](mailto:ghasty@iuhealth.org)